

**Installation Guidance**  
**Model: BMW 3 Series E46 2000 to 2008 models**

There is nothing technically difficult to prevent the average DIY minded person from replacing the convertible top. The top is simply screwed and riveted to the various parts of the frame. No special tools / sewing or trimming skills are required. You simply remove the old convertible top and fit the new one to all the relevant fixing points on the frame. There are factors which will affect the fit of the new top. Take a good look at the old convertible top for signs of damage or poor fit. This can sometimes be due to a worn or badly adjusted folding frame that will need attention. There is no substitute for some experience, so don't expect it to be easy first time around. You should allow approximately 5+ hours to complete the task and a second pair of helping hands is necessary. Convertible tops must be fitted in a warm dry environment. The material will be pliable and easier to stretch when warm. These guidance notes will help you remove the old convertible top and install the new one in the correct sequence. As you remove the old convertible top you will get a much clearer indication of the re-fitting procedure. The old top will be a valuable point of reference during the installation of your new convertible top. It may help if you take photographs of the removal of your old top to use for reference.

**Tools required:** Pop rivet gun and a selection of 5/32 rivets. 5/32 drill bits to drill out existing rivets and a selection of screwdrivers, torx bits, hex bits and spanners. Double sided tape is also required.

**Important:** Before removing the old convertible top check the new one carefully. Is the new top the correct model / colour / material etc? Are there any obvious signs of faults or damage? You don't want to find this out after you have removed the old one so please check the new top carefully. You can loosely drape it over the old one for direct comparison.

### **Removing Old Top**

Unclip convertible top from the front and fold half way back.

1. Raise the rear of the convertible top and remove the screws from the rear retaining channel that runs along the outer edge of the top (Picture 1). Once removed, lay the channel in the rear well.
2. Locate the rubber seal on the side upright of the frame (Picture 2). Open the seal from the middle and drill out the rivets that attach the seal to the frame. Do this on both sides.
3. Release the headlining from the rear window. The headlining is attached to the window using spring clips and is simply pulled out of the clips (Picture 3). Once the headlining has been released, fold the convertible top away from the rear and lay it on the roof section. This will reveal the rear frame bow. **You will have to remove the clips from the window surround of your old convertible top and install them in the window surround of the new top.**
4. Remove the 3 screws that attach the headlining to the rear frame bow (Picture 4).
5. Fold the convertible top back further to reveal the next frame bow. Remove the screws that attach the headlining and webbing straps to the frame bow and fold the convertible top away from frame bow.
6. Remove the moulded plastic trim that is attached at the front of the car to the header rail. A 2.5 hex bit will be required and there is a nut in each corner to remove. The nuts are covered by a black plastic cap (Picture 5).
7. Locate the front rubber seal that's attached to the frame above the side window on each side. Open the middle of the seal and you will see torx screws. Remove the torx screws using a T30 torx drive.

8. Remove the clips that attach the side cables to the frame and pull the side cables through the pocket to free them from the convertible top. The cables are attached at the front to the header rail (Picture 6).
9. Locate the side strap on the convertible top that is situated above the side windows approximately half way along the window aperture. The strap is attached to the frame on both sides using a Torx screw. Remove the torx screw using a T15 torx drive.
10. Fold the convertible top away from the frame bow to reveal the third frame bow. Remove the screws that attach the headlining to the frame bow and fold the convertible top away to reveal the front frame bow.
11. Remove the Torx screws that attach the headlining to the front frame bow and peel the last strap from the header rail. A second person is required to hold the plastic moulding as it will drop along with the headlining.

The old top and the headlining should now be fully released from the frame. Now would be a good time to check the frame for any signs of wear or damage. Check it moves freely both up and down. Check for any irregularities in its operation and that it is correctly aligned by checking the gaps between the frame, car body, tops of doors etc are correct and even on each side of the vehicle.

## **Installing the New Top**

**Before you begin, please install the headlining clips from the window surround of your old top into the window surround of the new top. There will be two spare that aren't required.**

1. Fit the front of the convertible top to the header rail using the front pocket.
2. Apply double sided tape to the header rail and attach the front bow strap.
3. Fit the front plastic moulding, whilst ensuring the front bow strap is sandwiched between the header rail and the moulding. The headlining retaining bar is then placed on the front plastic moulding with the headlining in place. Everything is held together using Torx Screws.
4. Apply double sided tape to the next frame bow and attach the bow strap and headlining to the next frame bow.
5. Feed the side cables into the side pockets and clip to the frame at the front using the spring clips.
6. Attach the side straps to the frame.
7. Attach to the frame the rubber seals that are situated at the front above the side windows
8. Apply double sided tape to the next frame bow and attach the bow strap, webbing straps and headlining.
9. Apply double sided tape to the rear bow and attach the bow strap, headlining bar and headlining to the rear bow.
10. Fold the rear of the convertible top upwards and clip the headlining into the window surround. Pull the rear plastic skirt of the convertible top over the rear of the frame.
11. Attach the rubber seals to the side uprights of the frame.
12. Attach the rear retaining channel to the rear of the frame making sure the rear plastic skirt of the convertible top is sandwiched between the channel and the frame.
13. Close the convertible top.

The new top may be very tight at first. This is normal. It should be kept closed for at least 1 week to allow excessive tension to dissipate. Never leave your top folded down for more than 24 hours or shrinkage can occur. Observe car manufacturer's instructions when folding and caring for your top.

## Pictures

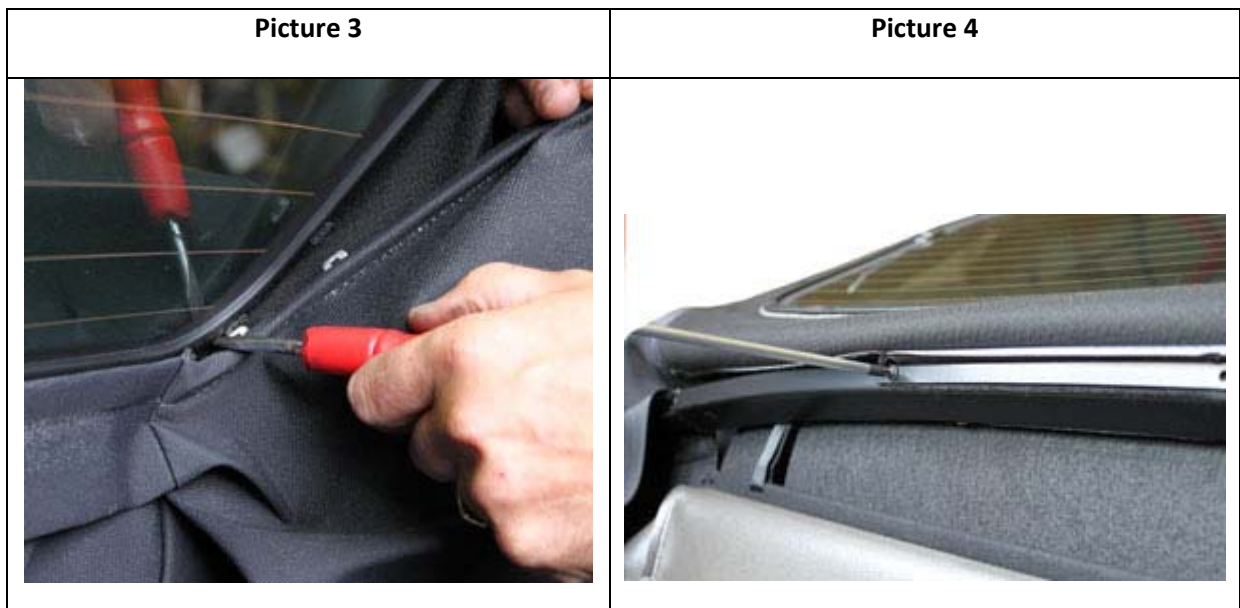
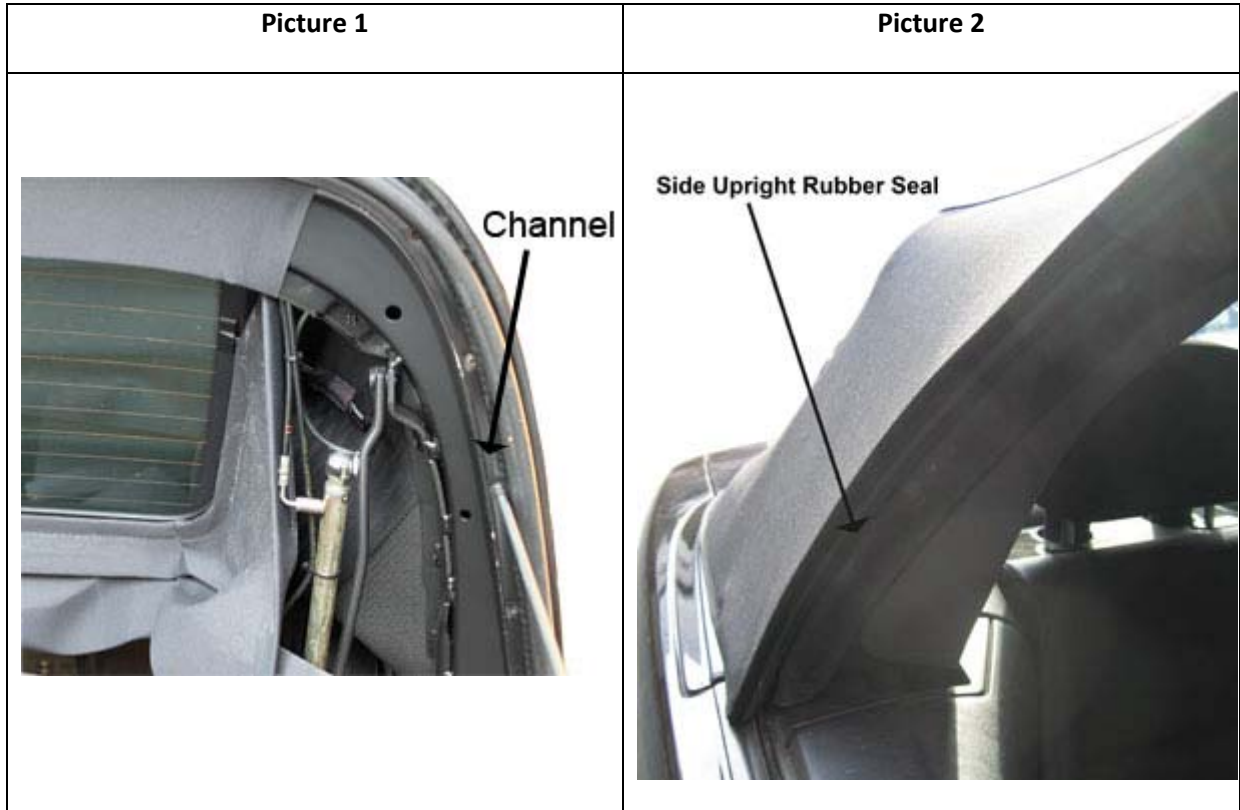

**Picture 5**



**Picture 6**

